

# PIH-232X/234X

- Weather & Impact Resistant Design
- 3-Axis Camera Construction
- Tamper-proof Screws
- Polycarbonate Dome Cover & Aluminum Die-cast Housing
- 3X High Definition Manual Varifocal Lens
- AC 24V / DC 12V Dual Voltage Input
- RCA Video Connector for Easy Adjustment on Site

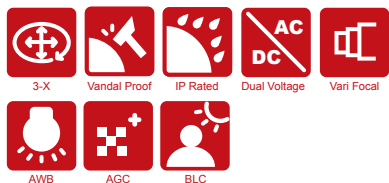

## Vandal Resistant Varifocal Camera



### Dimension Unit : mm

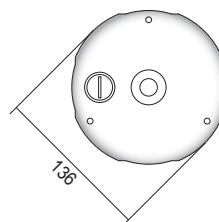
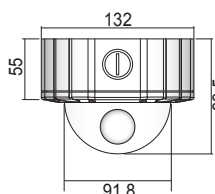

### Specifications

Model	Standard Resolution		High Resolution	
	PIH-2326XN	PIH-2326XP	PIH-2346XN	PIH-2346XP
System	NTSC		NTSC	PAL
Power Input Voltage	DC12V ±10% / AC24V ±10%			
Lens	Focal Length		3~9mm	
	Iris		F1.4	
	Angle of View	H	90.2°~ 31.8°	
		V	66.3°~ 23.9°	
D		115.3°~ 39.7°		
Pick Up Element	Sony 1/3" Super HAD CCD Sensor			
Effective Pixels	510(H) x 492(V)	500(H) x 582(V)	768(H) x 494(V)	752(H) x 582(V)
Chip Size	5.59mm(H) x 4.68mm(V)			
H / V Sync. Frequency	15.734KHz / 59.94Hz	15.625KHz / 50Hz	15.734KHz / 59.94Hz	15.625KHz / 50Hz
Sync. Mode	Internal			
Scanning System	2 : 1 Interlace			
Resolution	380 TV Lines		480 TV Lines	
Min. Illumination	0.1 Lux / F1.4		0.18 Lux / F1.4	
S/N Ratio	More than 50dB (AGC OFF)			
Auto Gain Control	36dB Variable Gain			
White Balance	ATW			
Aperture Gain Correction	Horizontal, Vertical			
Back Light Compensation	Auto			
Video Output	CVBS1.0Vp-p , 75Ω			
Gamma Characteristic	γ = 0.45			
Power Consumption	DC12V / 3.0W ; AC24V / 2.5W			
Vandal Proof	Withstand a blow from a 10lbs Sledgehammer			
IP Rating	IP 68			
Operating Temperature	-10°C ~ +50°C (14°F ~ 122°F)			
Dimension	Dome : Φ91.8, Base & Fix Ring : Φ136 x 55mm			
Weight	1200g			

Design and specifications are subject to change without notice.