



CDC0501 / CDC0502

Control Units for Pan-and-Tilt Heads

- Control of pan-and-tilt heads and zoom lenses
- Up to 64 positions can be stored: zoom/focus and pan/tilt positions (only with CDC0502)
- Direct control from a control panel (e.g. CKA3210, CKA4810, ...)
- Control via SIMATRIX SYS, 648 and 164 video matrix systems
- Transmission rate selectable from 2400 to 19200 bps
- 4 LEDs for operating status indication

The control units convert the control commands from the "control center" into electrical signals for the motors in the pan-and-tilt drive. The units can be driven either via a SIMATRIX SYS, 648 or 164 video matrix or from the CKA3210, CKA4810 and SUT48 control keyboards directly.

Both the CDC0501 and CDC0502 control units are designed for operating pan-and-tilt heads with a power supply of 230 or 115 V AC. Up to 99 addresses can be selected using DIP switches.

With the CDC0502 control unit, up to 64 pan/tilt or lens (zoom/focus) positions can be stored.

Dimensions in mm

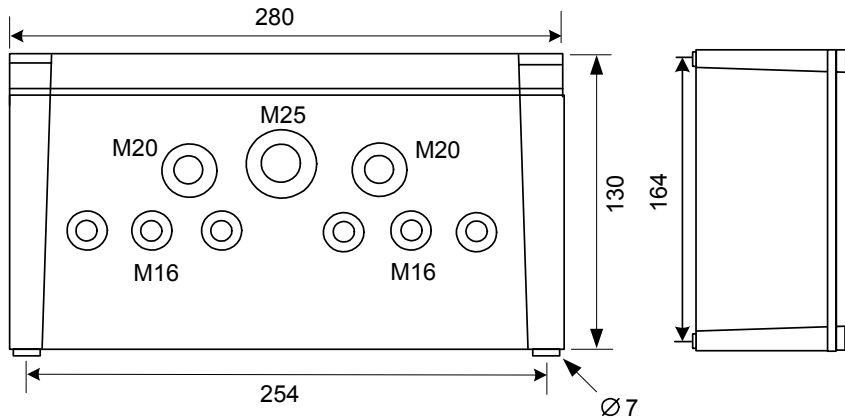

Technical data

Power supply	AC 230 V / AC 115 V, 50/60 Hz, selectable
Power consumption	approximately 70 VA
Fuses	
F 1	630 mA slow-blow / AC 115 V 315 mA slow-blow / AC 230 V
F 2	315 mA slow-blow / AC 115 V 160 mA slow-blow / AC 230 V
Pan/tilt device power supply	AC 24 V, 50 Hz; switchable to AC 230 V / AC 115 V, 50 / 60 Hz
Controllable pan/tilt heads	AC 24 V, 50 / 60 Hz, 13 W per motor and AC 230 V, 50 Hz, 13 W per motor
Lens power supply	DC 5 to 15 V
Controllable lenses	Control signal polarity reversal / common and two control lines: DC 5 to 15 V, 200 mA
Camera power supply	DC 12 V, 700 mA AC 24 V, 15 W
Heather power supply	AC 24 V, 1 A
Cable gland into the housing	6 x M16, for cable diameter 5 to 10 mm 2 x M20, for cable diameter 8 to 13 mm 1 x M25, for cable diameter 11 to 17 mm
Data inputs	TTY 20 mA (looped through), RS232, RS422 / RS485
Data outputs (camera control)	TTL, RS422 / RS485
Position memory (only with CDC0502)	64 positions
Dimensions (W x H x D) in mm	280 x 190 x 130 (without cable glands)
Permissible ambient temperature in °C	-20 to +50 (operation), indoors or outdoors, no direct exposure to sunlight
Degree of protection (housing)	IP66

Ordering data

Type	Order No.	Designation	Approx. weight in kg
CDC0501	S24245-B5015-A1	Control unit CDC0501 for pan/tilt head, without position memory	2.85
CDC0502	S24245-B5017-A1	Control unit CDC0502 for pan/tilt head, with position memory (64 positions)	2.85
Installation	2GF1714-8WN	Installation of a 2-wire transmitter	